

# THE TRIBUNE

AN ADVENTURE IN TREASURE HUNTING

INSTRUCTION  
MANUAL

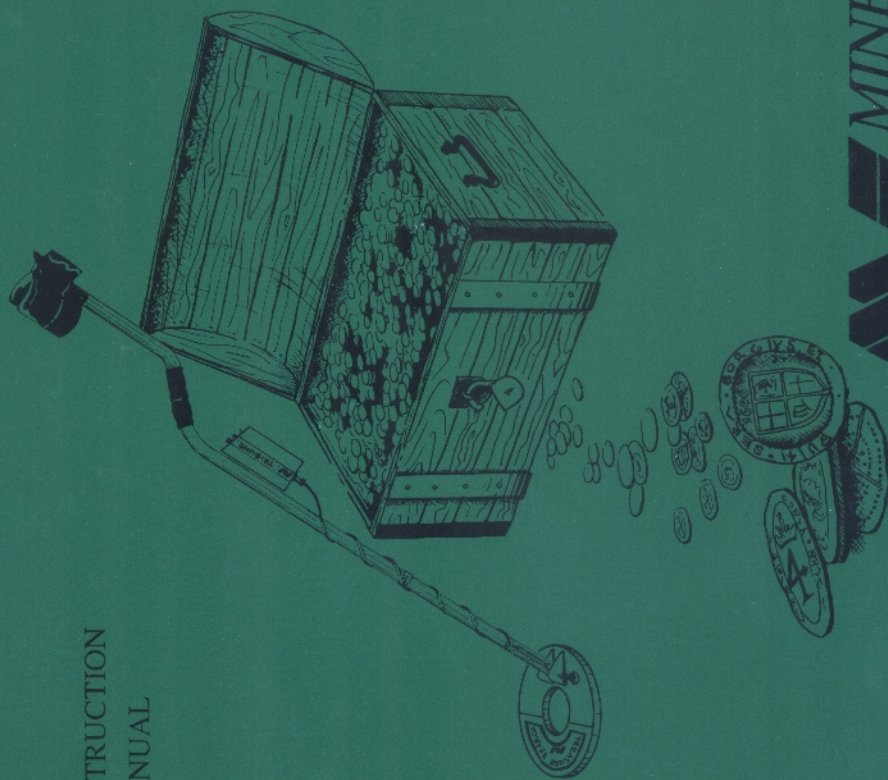

**MINELAB**  
ELECTRONICS  
PTY. LIMITED

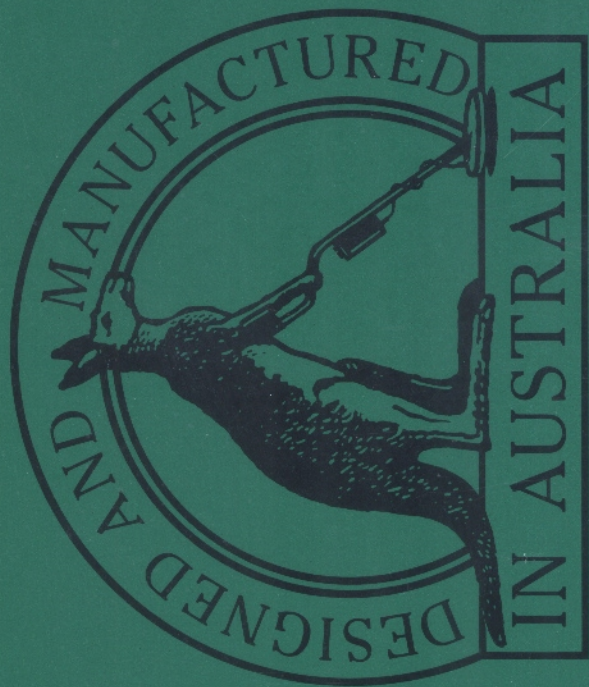

REG. TM

**MINELAB ELECTRONICS PTY LTD**

52 Sydenham Road, Norwood,  
South Australia 5067

Phone: 363 0899 Fax: 363 0973

Area Codes: National (08) International (618)

4901-0012

## I. CONTENTS

1. CONTENTS .....	1
2. INTRODUCTION .....	2
3. UNPACKING AND MECHANICAL SET UP .....	3
3.1. CONTENTS .....	3
3.2. BATTERIES .....	4
4. THE CONTROLS .....	5
4.1. SENSITIVITY CONTROL & ON / OFF SWITCH .....	5
4.2. MODE SWITCH ( DISCRIMINATION / PIN POINT) .....	6
4.3. DISCRIMINATION CONTROL .....	6
4.4. RESET SWITCH .....	7
4.5. AUDIO OUTPUT .....	8
5. OPERATING INSTRUCTIONS .....	8
6. HUNTING TIPS .....	9
7. ENVIRONMENTAL CONCERNS .....	10
8. DETECTOR CARE AND TROUBLE-SHOOTING .....	10
8.1. Proper Care of Your Detector .....	10
8.2. Trouble-shooting .....	11
9. WARRANTY AND SERVICE .....	11
10. SPECIFICATIONS .....	12

## 2. INTRODUCTION

Congratulations on purchasing **The Tribune**. This metal detector has been designed with the hobbyist and treasure hunter in mind. The main features include **light weight, quick shut down** between targets, **simplified controls** for operation and **substantial depth capabilities**.

**The Tribune** is designed to **locate valuable metal objects** in high trash areas. These conditions are commonly encountered by treasure hunters in places that have been inhabited for long periods or by competition hunters where "hunt fields" have been planted in areas used for picnics such as camping grounds.

**The Tribune** has been designed to serve the needs of both the speed hunter and the slow motion hunter as the unit may be moved at a "rapid hunt pace" or at a much more "leisurely" pace while enjoying the quick shut down between targets in either mode - without sacrificing depth capabilities. You will be surprised at how well **The Tribune's** depth capabilities will challenge other fixed ground balance units currently on the market!

**The Tribune's** operating frequency has been set at 5 kHz. This frequency has been chosen for its high level of sensitivity to targets such as coins, while being able to accurately discriminate against iron. **The Tribune** will also detect all gold, brass and other non-ferrous items.

With **The Tribune** Minelab has set out to provide you with a high performance, easily operated, lightweight detector which is available at a realistic price. To be a successful treasure hunter you must understand your detector as fully as possible; research your intended hunt area and respect the environment while you are hunting. We at Minelab are confident that **The Tribune** will provide you with hours of enjoyment for all types of hunting: whether on the beach, in the country, or in a competition hunt.

If you have any questions, comments or criticisms we would like to hear from you. Please contact your local Authorised Minelab Dealer or write to us direct.

**We wish you every success in your treasure hunting.**

Minelab Electronics Pty. Limited  
Box 35  
Stepney  
South Australia 5067.

## 3. UNPACKING AND MECHANICAL SET UP

### 3.1. CONTENTS

Unpack your detector and ensure that the following parts are included: Armrest, Grey upper shaft, Grey intermediate shaft, Grey lower shaft, Treasuresearch coil, Tribune control box, Battery holders, Instruction manual and Warranty card.

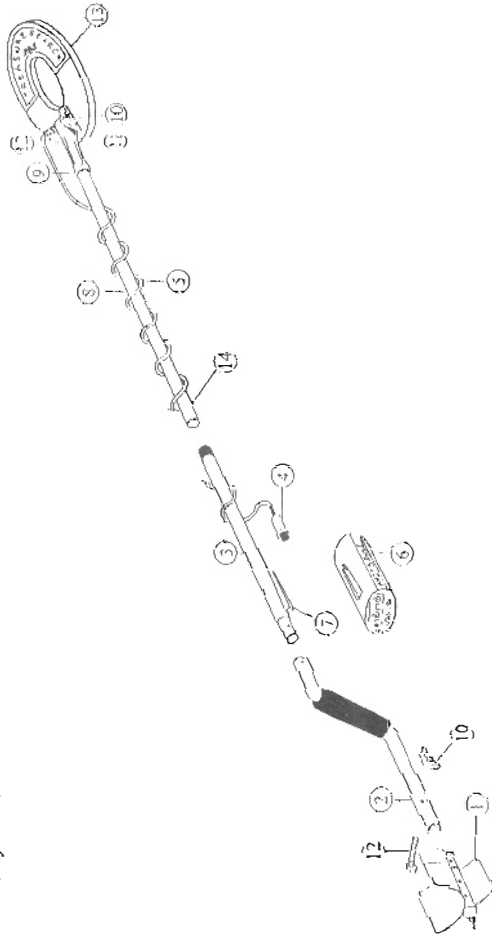

Figure 1. Tribune Assembly Diagram.

Fill in the warranty card and mail it.

Remove the Nylon Bolt and Wingnut from the Armrest.

Slide the arm rest (1) (with support fins towards the rear) over the back of the Grey upper shaft (2) so that holes in the armrest line up with the holes in the Grey upper shaft at a comfortable position for the length of your arm.

Push the Nylon Bolt (12) through the aligned holes in the Armrest and shaft. Tighten the Wingnut (10) by hand to hold the armrest firmly in place.

Slide Grey intermediate shaft (3) into Grey upper shaft (2) until it "clicks" in place, so that the Receiving bracket (7) is positioned as per the diagram.

Remove the Nylon Bolt (12) and Wingnut (10) from the Coil end of the Grey Lower Shaft (8), ensure that the two Teardrop Washers (11) remain in the recess of the black plastic moulding (9).

Push the black moulded part, containing the two teardrop washers, of the Lower Grey Shaft between the shaft mounting brackets on the coil, ensures the spring clip (14) at the other end of the shaft is facing away from the centre of the coil. Line up the holes in the black moulded part with the holes in the shaft mounting brackets on the coil.

Push the Nylon Bolt (12) through the shaft mounting bracket and black moulding from the cable side of the coil, tighten the Nylon Wingnut (10) by hand so that coil is held firm. Do not over tighten!

Slide the Grey lower shaft assembly (8) into the Grey intermediate shaft (3) until the clip snaps into place at a convenient length for your height.

Attach the control box (6) to the Grey intermediate shaft (3) by sliding the wedge clip on the control box into the Receiving bracket (7) on the main shaft. Push it firmly in until it is secure.

Wind the cable from the Treasuresearch coil (13) around the shaft fairly tightly (but without strain) and connect and screw the Cable plug (4) to the socket on the control box.

Install the batteries and you are ready to start searching.

### 3.2. BATTERIES

The Tribune is powered by 8 'AA' Alkaline batteries. The battery holders are accessible through the back of the control box by simply loosening the knurled nuts at the rear of the unit. Withdraw the battery holders and fit your alkaline batteries.

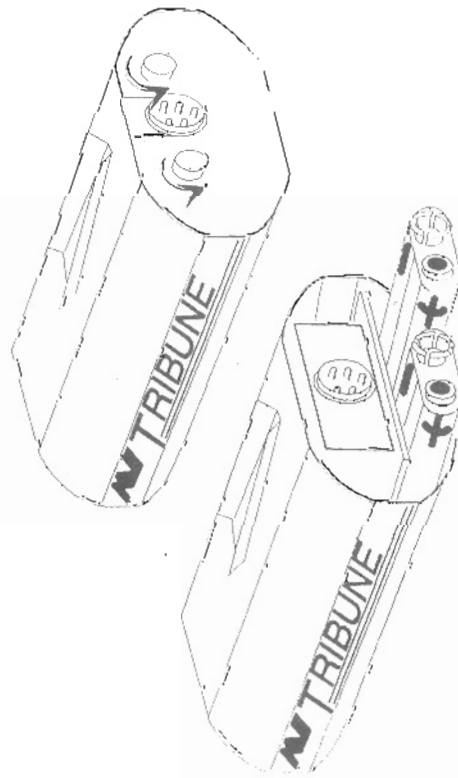

High quality alkaline batteries should be used instead of standard carbon batteries. Alkaline batteries will operate The Tribune for about 40 hours. Use of headphones will conserve the battery life.

When the batteries are reaching the point at which they will no longer operate "The Tribune", a short tone will be heard from the speaker (or headphones) approximately every 30 seconds. When this tone is heard, there will be approximately 15 to 20 minutes of life left in the batteries. It is recommended that the batteries be replaced as soon as possible to avoid missing any targets.

## 4. THE CONTROLS

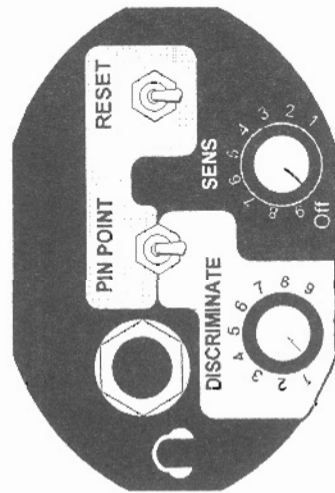

### 4.1. SENSITIVITY CONTROL & ON / OFF SWITCH

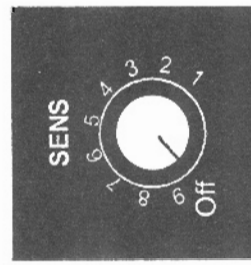

This knob is located in the lower right hand corner of the Control Box. It allows the unit to be turned on and off as well as controlling the sensitivity. This control is often thought of in terms of a depth control and it is to a point, but it also makes the unit more sensitive to interference caused by such things as ground chemistry "mineralisation" or electrical fields.

In most cases this control should be set in the furthest anti-clockwise position (9) without actually turning the unit off. If interference is received in the form of popping or chattering it is advisable to turn the knob clockwise just enough to remove the interference.

Note: if you are in a competition hunt where the coins are only 2" to 3" deep the need for maximum sensitivity is not necessary as it allows you to receive signals from similar machines on the hunt field as interference. Two detectors may cause interference if operated very close to each other.

